

DRAWING NO : J 151

BCV KAILA

UPDATED: : 12/12/2005

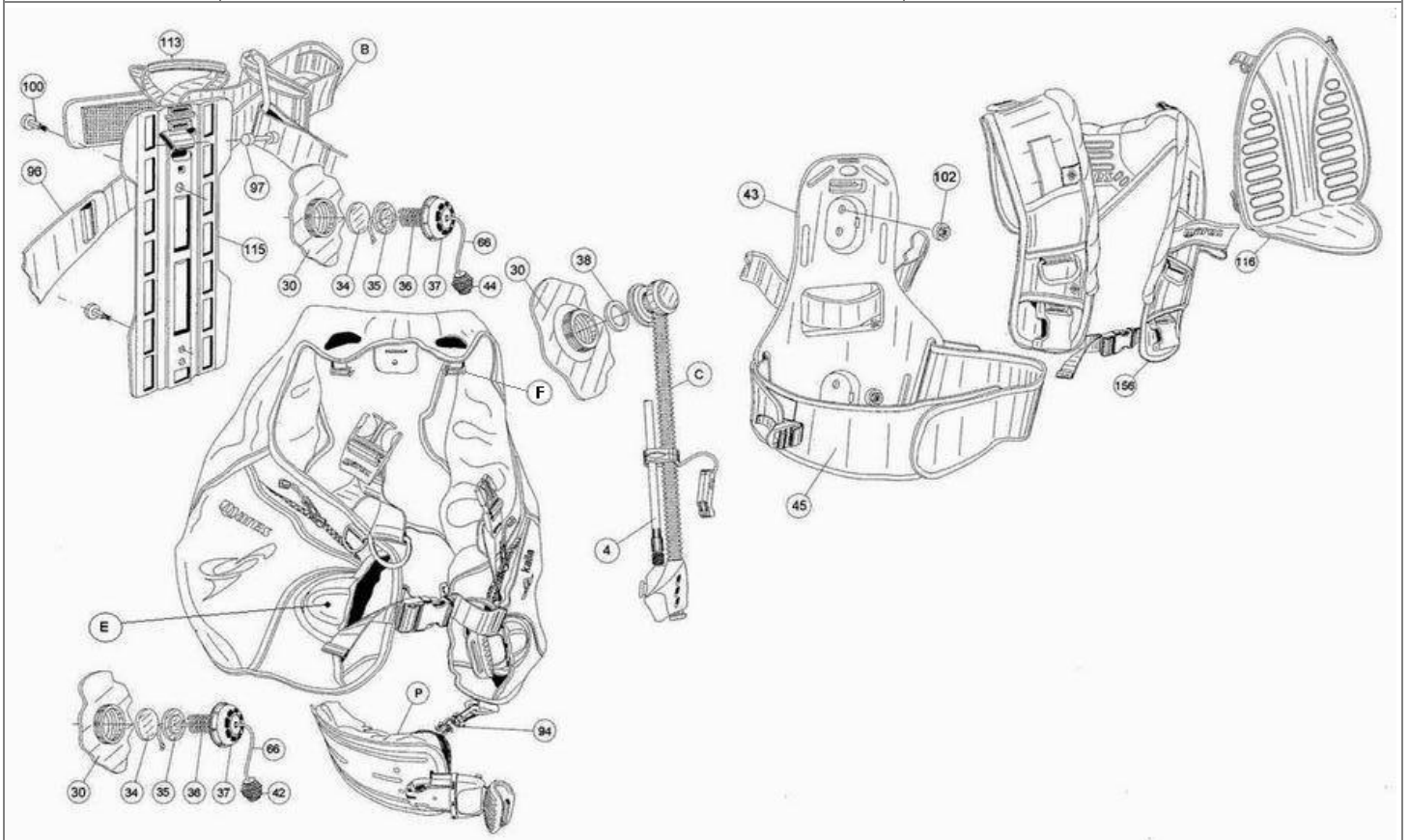

CHART NO : 269

B.C.VEST KAILA

UPDATED: 22/12/2008

REF	CODE	DESCRIPTION	€	REF	CODE	DESCRIPTION	€
4	47159681	INT HOSE, LP INFLATOR		96	47159311	RUBBER EXTRUSION, TANK BAND, BC	
30	N/D	KAILA BLADDER		97	47159293	SCREW, TANK BAND	
34	47159125	SEAL, OVERPRESS. VALVE, B.C.V.		98	47158567	BUCKLE, DOUBLE REG. 40 F DWSR	
35	47159054	SEAT DISC, OP VALVE B.C.VEST		98	47158566	BUCKLE, DOUBLE REG. 40 M DWSR	
36	47159150	SPRING, RAPID EXHAUST VALVE		100	47158522	SCREW M 6 x 20	
37	47159056	CAP, O.P. VALVE, B.C.VEST		102	47159748	FLANGED NUT M6	
38	47159124	SEAL, CONNECTING LOCKNUT B.C.		113	47159609	HANDLE, BACK PACK	
42	47158505	PULL KNOB GREY		115	47159160	COUNTER BACK PACK	
43	47200219	BACK PACK 2K2		116	47200791	BACK ACK PADDING	
44	47159136	PULL KNOB R.E. VALVE BLACK		156	47200891	SHOULDER STRAP SMALL	
45	47200893	WAISTBAND KAILA XXS		156	47200892	SHOULDER STRAP BIG	
45	47200894	WAISTBAND KAILA XS		ASSEMBLED			
45	47200895	WAISTBAND KAILA S		B	47159295	TANK BAND ASSEMBLY - SINGLE TANK	
45	47200896	WAISTBAND KAILA M		A	47159729	ERGO INFLATOR ASSY, LONG ref chart 255	
45	47200897	WAISTBAND KAILA L		x x x	47159058	RAPID EXHAUST KIT(34-35-36-37-44-66)	
66	43169822	LINE, BLACK, DIAM. 1,75		E	47200925	MRS PLUS, PLATE/BUCKLE KIT	
94	415157	HOSE RETAINER CLIP		F	47159302	LL 25 BLACK ACETALIC	