

DRAWING NO : J 153

B.C.VEST F-LIGHT

UPDATED: 22/12/2010

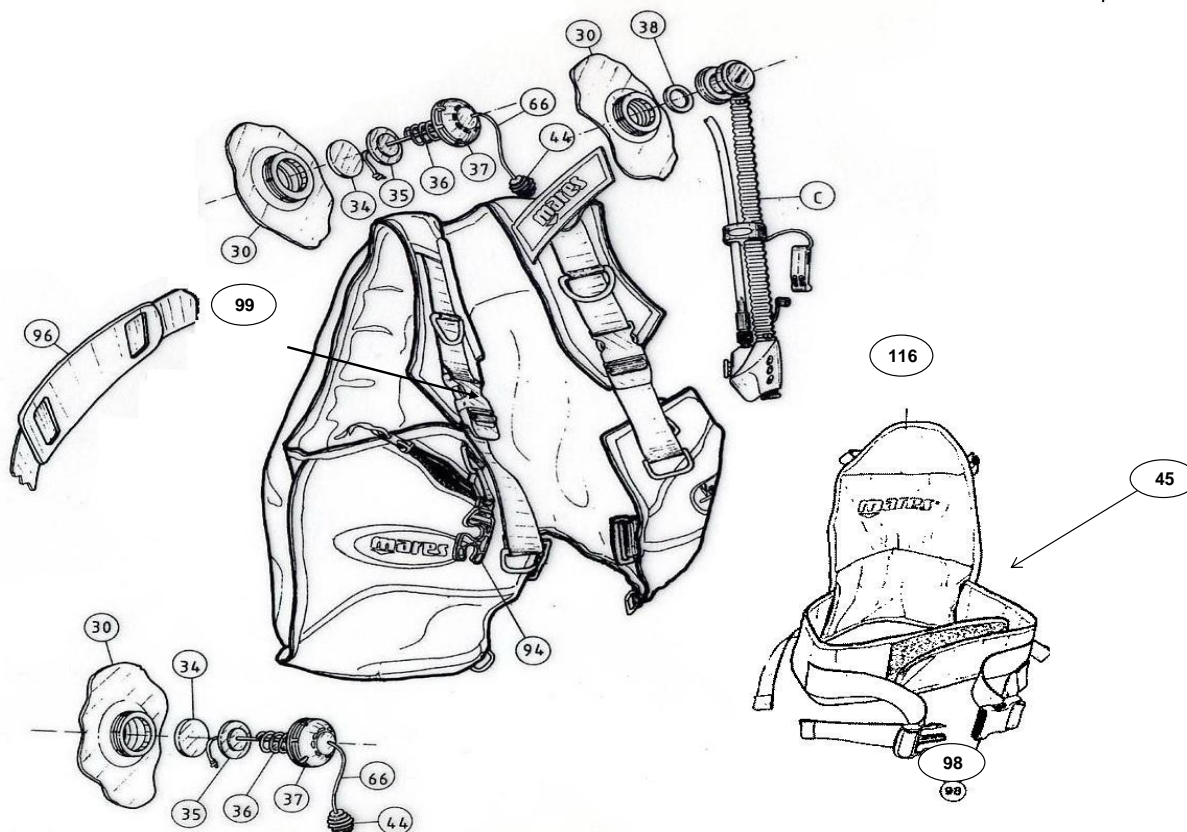

CHART NO : 271

BCV F-LIGHT

UPDATED : 22/12/2010

REF	CODE	DESCRIPTION	€	REF	CODE	DESCRIPTION	€
4	47159681	INT HOSE, LP INFLATOR		45	47201076	WAISTBAND XL	
30	N/A	BLADDER		66	43169822	LINE, BLACK, DIAM. 1,75	
34	47159125	SEAL, OVERPRESS. VALVE, B.C.V.		94	415157	HOSE RETAINER CLIP	
35	47159054	SEAT DISC, OP VALVE B.C.VEST		96	47159311	RUBBER EXTRUSION,TANK BAND,BC	
36	47159150	SPRING, RAPID EXHAUST VALVE		98	47158567	BUCKLE, DOUBLE REG. 40 F DWSR	
37	47159056	CAP, O.P.VALVE, B.C.VEST		98	47158566	BUCKLE, DOUBLE REG. 40 M DWSR	
38	47159124	SEAL, CONNECTING LOCKNUT B.C.		99	47158569	BUCKLE SR 40 F	
44	47159136	PULL KNOB R.E.VALVE BLACK		99	47158568	BUCKLE SR 40 M	
45	47201072	WAISTBAND XS		116	47201077	BACK PACK PADDING	
45	47201073	WAISTBAND S		ASSEMBLED			
45	47201074	WAISTBAND M		A	47159729	ERGO INFLATOR ASSY, LONG ref chart 255	
45	47201075	WAISTBAND L		x x x	47159058	RAPID EXHAUST KIT(34-35-36-37-44-66)	

